

Li'l GIANT Tricycle

Owner's Manual

Assembly and Maintenance

PLEASE READ THE FOLLOWING BEFORE BEGINNING ASSEMBLY:

Before assembling your Li'l GIANT tricycle all of us at GIANT strongly encourage you to read this manual. In return for the time spent reading this manual and learning about your new Li'l GIANT tricycle you will be rewarded with many hours of safe bicycling.

WARNING! WE RECOMMEND THE USE OF A SAFETY HELMET APPROVED BY THE CONSUMER PRODUCT SAFETY COMMISSION (CPSC) FOR ANY CHILD USING THIS RIDE-ON TOY.

WARNINGS!

DO NOT ALLOW CHILDREN TO RIDE THIS TRICYCLE WITHOUT ADULT SUPERVISION!

- This ride-on toy is designed and manufactured for OFF STREET USE ONLY!
- It is not equipped with a braking device. As a result, it must not be used near swimming pools, on or near steps, hills, roadways, on wet slippery or rough terrain, on inclines, near stairways, around moving or parked cars, or in congested areas. Failure to heed this warning may result in serious injury or death to the rider.
- The minimum rider's weight for this ride-on toy is 25 lbs. (11.5 K) – maximum 75 lbs. (35 K), and the minimum inseam is 15 in. (38 cm).
- Keep small parts, hardware and plastic bags out of the reach of children. Failure to do so could result in serious injury or death.
- This ride-on toy designed to carry only one passenger. Attempts to carry more than one rider could destabilize the tricycle and cause it fail or tip over, which could result in serious injury or death.
- Never let children ride this toy at night.
- Never leave child riders unattended.
- Children should wear shoes at all times when playing with this ride-on toy.

WARNING! This tricycle requires assembly by a capable adult. If you are not absolutely sure of your ability to do this properly, have the tricycle assembled by a professional mechanic at your local Authorized GIANT Retailer. This instruction sheet has been designed in step-by-step order for correct and easy assembly. Please follow the sequence as described. The total time for assembly should be between 30 minutes and 1 hour. Inspect the tricycle before it is ridden, and be sure that all parts are assembled securely.

IMPORTANT! Remove the tricycle and all of its parts from the carton prior to assembly and lay them out on a flat surface. Compare the contents of the carton with the diagram (see Fig. 1) to be sure that you have everything.

MAINTENANCE:

Your Li'l GIANT is a quality tricycle. It has been constructed utilizing quality components and fasteners. Contact your local Authorized GIANT Retailer for replacement parts and service. With periodic maintenance, common sense usage, and care this tricycle can provide many years of riding enjoyment. Periodically check all of the fasteners to insure that everything is securely tightened. Check the handlebars to make sure that they secure. Replace any broken or worn parts as necessary.

Figure 1

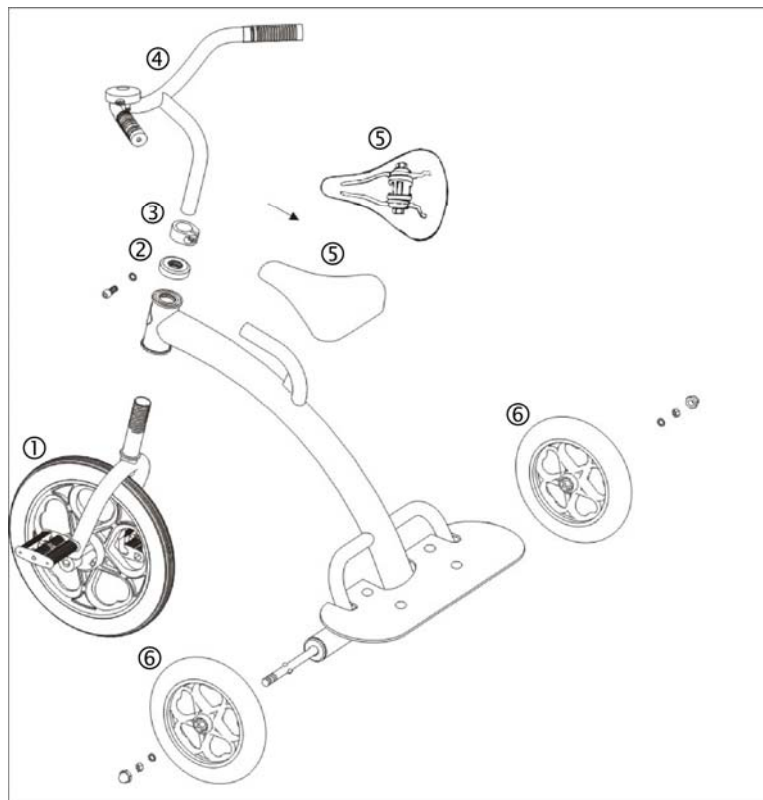

STEP #1 – Install Front Wheel/Fork Assembly

Install the Front Wheel/Fork Assembly (item#1) by inserting the threaded steerer tube of the front fork into the bottom opening of the head tube on the front end of the frame until the top of the steerer tube passes through the head tube and the remainder is exposed above the top of the head tube. Check the wheel retainers at the bottom of the front fork using 2 – 5mm hex wrenches (not included) to insure that they are securely tightened.

STEP #2 – Install the Handlebar Assembly and Headset Retainer

Hand thread the Headset Lock Ring (item# 2) onto the fork steerer tube until it is snug against the upper headset cup at the top of the head tube. The Headset Lock Ring should be no more than hand tight and the front fork should turn freely in the head tube without rattling. If the fork does not turn freely then you should back the Headset Lock Ring off until it does turn freely. If the fork rattles or feels loose in the head tube then you should tighten the Headset Lock Ring further until the fork feels solid in the head tube, but still turns freely.

Now install the Steerer Tube/Stem Clamp (item# 3) by sliding it over the top of the steerer tube. Position the clamp slot towards the front of the bike – away from where the rider will be seated.

Insert the stem portion of the Handlebar Assembly (item# 4) into the steerer tube until the hashed line above the words “Minimum Insertion” (stamped on the Handlebar Assembly) is below the top of the steerer tube. Position the Handlebar Assembly so that the extension of the stem is in line with the front wheel and the handlebar is roughly perpendicular to the front wheel. Then, using a 6mm hex wrench (included), tighten the Steerer Tube/Stem Clamp until Handlebar Assembly is secure in the steerer tube. (If necessary, use a Phillip’s screwdriver – *not included* – to loosen the clamp bolt on the bell installed on the Handlebar Assembly to reposition or adjust its location.)

STEP #3 – Install the Rear Axle and Wheels

- a) Examine the rear axle (item# 7). Notice the flat ears formed on one end of the axle. Install the axle in the frame by inserting the end of the axle without the ears into bushing on one end of the rear axle casing of the frame first. Pass the axle through the casing until the end of the axle passes through the bushing on the opposite end of the casing and the ears mate with the keyway of the first bushing. At this point the axle should not be able to rotate in the frame.
- b) Install one of the rear wheels (item# 6) onto the end of the axle, followed by a split lock washer. Now thread one of the 13mm domed nuts onto the end of the axle – *using the box wrench supplied* – until it snugs against the washer and the wheel. At this point the wheel should be able to spin freely on the axle without rattling. If the wheel does not spin freely, back off the

nut incrementally until it does. If the wheel spins freely but rattles or wobbles on the axle, tighten the nut until the wheel spins true.

- c) Repeat the wheel installation procedure for the second rear wheel.

STEP #4 – Install the Saddle and Clamp Assembly

- a) Install the Saddle and Clamp Assembly (item# 5) by sliding it onto the saddle-mounting spur on the frame. Be careful not to gouge the paint.
- b) The fore/aft position of the saddle can be adjusted by sliding the Saddle and Clamp Assembly along the saddle-mounting spur. In addition, the angle of the saddle can also be adjusted. Once the desired saddle adjustment is made – using a 6mm hex wrench – tighten bolt on the Clamp Assembly securely.

Now you're ready to ride!

Copyright 2002 GIANT Bicycle Inc. all rights reserved 8/2002